

CONNECT THREAD FITTING 234

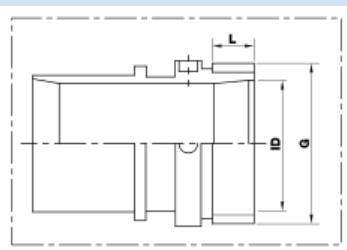

Threaded adapter

Applications

- food industry, pharmaceutical industry: food, pharmaceutical
- vacuum conveying equipment, vacuum hopper, suction conveyor, dosing system
- pelleting machines/ tablet presses

Properties

- thread reference DIN ISO 228
- conforms to RoHS guideline
- REACH according to --> Technology / Technical Information / REACH

Temperature range

- -40 °F to 195 °F

Delivery variants

- further diameters available on request
- gas- and liquid-tight as pre-fitted version

Size (in)	Thread	Weight (lb/pcs)	Suitable for hose I.D. (in)	Order No.
Thread adapter DIN ISO 228; aluminum; (please select the hose and the assembly separately)				
0.984	G1	0.265	Ø 25	234-0025-2917
1.260	G1 1/4	0.353	Ø 32	234-0032-2917
1.496	G1 1/2	0.397	Ø 38	234-0038-2917
1.575	G1 1/2	0.463	Ø 40	234-0040-2917
2.953	G3	0.882	Ø 76	234-0075-2917
3.150	G3	1.058	Ø 80	234-0080-2917
3.937	G4	1.544	Ø 101	234-0100-2917
Thread adapter DIN ISO 228; electro-galvanized steel; (please select the hose and the assembly separately)				
0.984	G1	0.794	Ø 25	234-0025-2918
1.260	G1 1/4	0.992	Ø 32	234-0032-2918
1.575	G1 1/2	1.345	Ø 40	234-0040-2918
2.559	G2 1/2	1.976	Ø 65	234-0065-2918
3.150	G3	3.087	Ø 80	234-0080-2918
3.937	G4	4.476	Ø 101	234-0100-2918
Thread adapter DIN ISO 228; stainless steel 1.4301 (stamped) = AISI 304; (please select the hose and the assembly separately)				
0.984	G1	0.794	Ø 25	234-0025-2919
1.496	G1 1/2	1.147	Ø 38	234-0038-2919
1.575	G1 1/2	1.345	Ø 40	234-0040-2919
1.969	G2	1.874	Ø 51	234-0050-2919
2.559	G2 1/2	1.976	Ø 65	234-0065-2919
2.953	G3	2.205	Ø 76	234-0075-2919
3.150	G3	3.087	Ø 80	234-0080-2919
3.937	G4	4.476	Ø 101	234-0100-2919
Thread adapter DIN ISO 228; Stainless steel 1.4404 (stamped) = AISI 316L; (please select the hose and the assembly separately)				
0.984	G1	0.794	Ø 25	234-0025-2920
1.260	G1 1/4	0.992	Ø 32	234-0032-2920
1.575	G1 1/2	1.345	Ø 40	234-0040-2920
1.969	G2	1.874	Ø 51	234-0050-2920

Positive and negative pressure ratings are the recommended maximum operating values. Products can be manufactured to meet higher operating values upon request. The bend radius is calculated from the center of the hose in an arched position. Additional information at www.norres.com/us/technology/. NORRES reserves the right to modify technical data at any time. Technical data based on tests at 68 °F and are approx. values. Proper use and maintenance of NORRES hoses is the sole responsibility of purchaser and ultimate user of the product. The individual conditions, applications and the number of variables make firm recommendations technically impossible. This information is intended as a general guide only.

CONNECT THREAD FITTING 234

Size	Thread	Weight	Suitable for hose I.D.	Order No.
(in)		(lb/pcs)	(in)	
2.559	G2 1/2	1.976	Ø 65	234-0065-2920
2.953	G3	2.205	Ø 76	234-0075-2920
3.150	G3	3.087	Ø 80	234-0080-2920
3.937	G4	4.476	Ø 101	234-0100-2920

Accessories



CONNECT SAFETY CLAMP ASSEMBLY 231



CONNECT PRESS ASSEMBLY 232



CONNECT MOULD ASSEMBLY 233