

# CONNECT 206

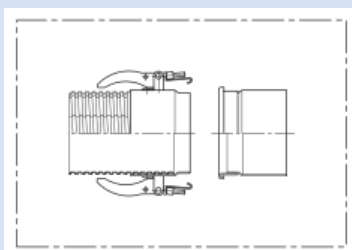
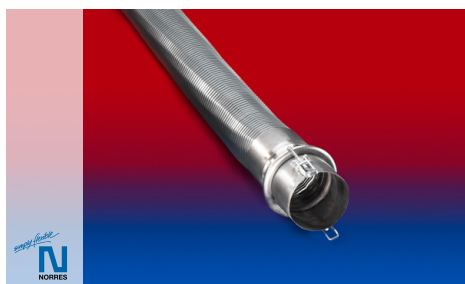

Connectors for connecting or attaching metal hoses

## Properties

- conforms to RoHS guideline

- Quick-release coupling 206**: quick-release coupling with several clamp clips, option of coupling with clamp clips or flange with flat face, extension at one end for attaching the metal hose
- REACH according to --> Technology / Technical Information / REACH

## Design

- Stainless Steel (INOX)

## Delivery variants

- further diameters available on request

No. clamp	Suitable for hose I.D.	Order No.
clips	(in)	
Assembly; (please select the hose separately); riveting		
-	-	206-0000-2905
Quick-release coupling 206 Coupling with clamp clips stainless steel (INOX)		
2	100	206-0100-2015
2	125	206-0125-2015
2	150	206-0150-2015
3	200	206-0200-2015
3	250	206-0250-2015
3	300	206-0300-2015
Quick-release coupling 206 flange stainless steel (INOX)		
2	100	206-0100-2016
2	125	206-0125-2016
2	150	206-0150-2016
3	200	206-0200-2016
3	250	206-0250-2016
3	300	206-0300-2016