

Abrasion-proof and electrically conductive suction and transport hose; PUR <math>< 10^3 \Omega</math>, medium-heavy, smooth interior

Applications: Abrasion-proof and electrically conductive suction and transport hose, especially suitable:

- for transporting inflammable bulk materials and in areas liable to contain explosive mixtures (explosion protection)
- for abrasive solids such as dust, powder, fibres, chips and granulates
- for gaseous and liquid media
- for de-dusting and suction plants, industrial vacuum cleaners, suction of paper and textile fibres

Properties

- medium-heavy model
- according to German TRBS 2153 electrically conductive wall: Electrical and surface resistance <math>< 10^3 \Omega</math>, recommended for transporting inflammable bulk materials

- highly abrasion-proof (abrasion resistance about 2.5 to 5 times better than most rubber materials and about 3 to 4 times better than most soft PVC 's)
- smooth interior
- optimized flow properties
- flexible
- high tensile strength and tear resistant
- good resistance to mineral oils and gasoline
- good resistance to chemicals
- good resistance to UV and ozone
- small bending radius
- kink-proof
- free of softener and halogen
- gas and liquid tight
- conforms to the requirements of the European ATEX Directive
- conform to RoHS guideline

Temperature Range

- -40 °C approx. to +90 °C approx.

Design, material

AIRDUC® profile hose

1. spring steel wire firmly embedded in wall
2. optimized flow properties
wall: electrically conductive premium ester-polyurethane (Pre-PUR®)
3. wall thickness 0.8 mm approx.

Delivery variants

- cut lengths and special lengths
- black (standard)
- customer-specific product marking
- wall: microbe and hydrolysis resistant and electrically conductive premium ether-polyurethane (Pre-PUR®)
- as a pre-assembled hose system with NORCONNECT connectors
- customised connectors

I.D. mm	O.D. mm	Rec. operating limits		Bending Radius mm	Weight kg/m	Stock Lengths m	Further Production Lengths m	Order No.
		Overpressure bar	Vacuum bar					
25	32	2,285	0,460	35	0,200	10	15	351-0025-1003
30	38	1,920	0,440	42	0,260	10	15	351-0030-1003
32	40	1,800	0,430	44	0,280	-	10 15	351-0032-1003
35	43	1,650	0,410	47	0,300	-	10 15	351-0035-1003
38	46	1,525	0,400	51	0,320	10	15	351-0038-1003
40	48	1,455	0,390	53	0,340	10	15	351-0040-1003
45	53	1,295	0,360	58	0,380	-	10 15	351-0045-1003
50	58	1,165	0,340	64	0,410	10	15	351-0050-1003
55	63	1,065	0,305	69	0,450	-	10 15	351-0055-1003
60	68	0,980	0,265	75	0,490	10	15	351-0060-1003
65	73	0,900	0,235	80	0,530	10	15	351-0065-1003
70	79	0,840	0,195	87	0,570	10	15	351-0070-1003
75	84	0,780	0,180	92	0,610	10	15	351-0075-1003
80	89	0,730	0,165	98	0,650	10	15	351-0080-1003
90	99	0,655	0,145	109	0,730	10	15	351-0090-1003
100	109	0,585	0,115	120	0,790	10	15	351-0100-1003
102	111	0,580	0,115	122	0,810	-	10 15	351-0102-1003
110	119	0,535	0,100	131	0,870	10	15	351-0110-1003
115	124	0,515	0,095	136	0,910	-	10 15	351-0115-1003
120	129	0,495	0,085	142	0,940	-	10 15	351-0120-1003
125	134	0,475	0,075	147	0,980	10	15	351-0125-1003
127	136	0,465	0,075	148	1,000	-	10 15	351-0127-1003
130	139	0,455	0,075	153	1,030	-	10 15	351-0130-1003
140	149	0,420	0,075	164	1,090	-	10 15	351-0140-1003
150	159	0,390	0,070	175	1,330	10	15	351-0150-1003
160	169	0,370	0,060	186	1,410	-	10 15	351-0160-1003



I.D.	O.D.	Rec. operating limits		Bending Radius	Weight	Stock Lengths	Further Production Lengths	Order No.
		Overpressure	Vacuum					
mm	mm	bar	bar	mm	kg/m	m	m	
170	179	0,350	0,060	195	1,500	-	10 15	351-0170-1003
175	184	0,340	0,050	202	1,550	-	10 15	351-0175-1003
180	189	0,330	0,050	208	1,590	-	10 15	351-0180-1003
200	209	0,300	0,050	230	1,760	10	15	351-0200-1003
203	212	0,290	0,050	233	1,800	-	10 15	351-0203-1003
225	234	0,265	0,035	257	2,200	-	10 15	351-0225-1003
250	259	0,240	0,020	285	2,430	10	15	351-0250-1003
275	284	0,215	0,020	312	2,630	-	10	351-0275-1003
280	289	0,215	0,020	318	2,670	-	10	351-0280-1003
300	309	0,195	0,015	340	2,860	-	10	351-0300-1003
315	324	0,185	0,015	356	3,000	-	10	351-0315-1003
320	329	0,185	0,015	362	3,050	-	10	351-0320-1003
325	334	0,185	0,015	367	3,100	-	10	351-0325-1003
350	359	0,170	0,015	395	3,330	-	10	351-0350-1003
375	384	0,155	0,010	424	3,900	-	10	351-0375-1003
400	409	0,145	0,010	450	4,270	-	10	351-0400-1003
450	459	0,130	0,010	508	4,800	-	10	351-0450-1003
500	509	0,120	0,010	565	5,330	-	10	351-0500-1003

Other diameters and lengths available on request. All values indicated here are approximate figures based on a temperature of 20 °C. Data subject to change without notice. Please also refer to our Technical Appendix on www.norres.com.

Accessories

13.1.0



NORCLAMP 212

13.5.0



NORCLAMP 212 EC

13.6.0



NORCLAMP 217

13.7.0



NORCLAMP 213

13.8.0



NORCONNECT 240 + 241

13.9.0



NORCONNECT 242

13.10.0

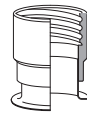

NORCONNECT 243

13.11.0

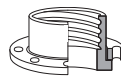

NORCONNECT 244

13.12.2



NORCONNECT 245 CSH

13.12.5



NORCONNECT INOX 245

13.13.0

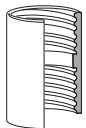

NORCONNECT 246

13.13.5



NORCONNECT 248

13.14.0

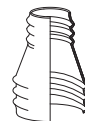

NORCONNECT 223

13.18.0

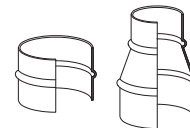

NORCONNECT 270-271